

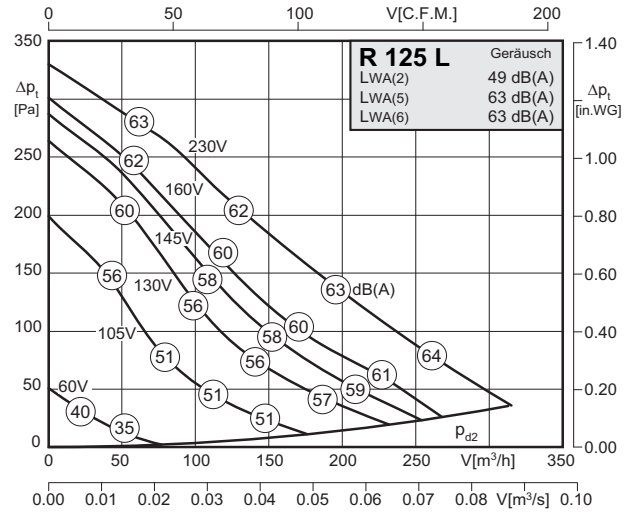

- Gehäuse aus verzinktem Stahlblech
- in allen Einbaulagen einsetzbar
- einfacher elektrischer Anschluss durch außenliegenden Klemmkasten
- Isolierstoffklasse F
- Motorschutz durch Thermokontakte
- transformatorisch und elektronisch 100% stufenlos steuerbar
- casing made of galvanized sheet steel
- easy installation in any position
- easy electrical connection via terminal box
- insulation class F
- motor protection by thermal contacts
- speed is 100% infinitely variable using auto transformers or electronic control

Technische Daten / Technical Data:

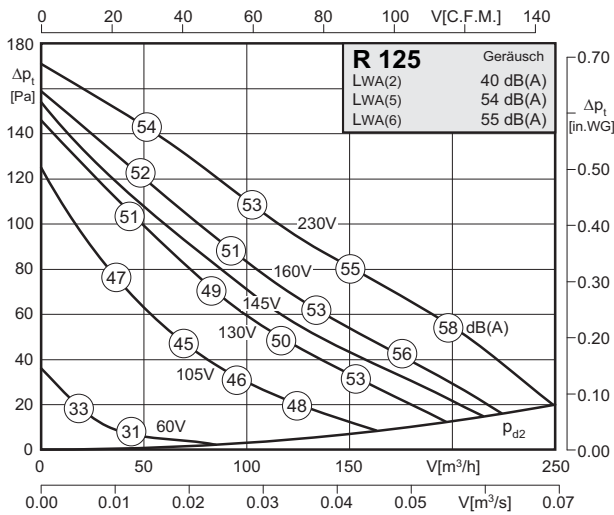

| Typ / Type: R 125 | | Art.-Nr. / Art.-No.: F00-12582 | |
|-------------------|------------------------|---------------------------------|--------|
| U | 230V (50Hz) | Δp_{fa} min | - Pa |
| P ₁ | 0.028 kW | ΔI | - % |
| I _N | 0.12 A | I _A / I _N | 1.7 |
| n | 2620 min ⁻¹ | | IP44 |
| C _{400V} | 1 μ F | | 01.009 |
| t _R | 70 °C | | 2,1 kg |

| Typ / Type: R 125 L | | Art.-Nr. / Art.-No.: F00-12587 | |
|---------------------|------------------------|---------------------------------|--------|
| U | 230V (50Hz) | Δp_{fa} min | - Pa |
| P ₁ | 0.065 kW | ΔI | - % |
| I _N | 0.30 A | I _A / I _N | 1.5 |
| n | 2480 min ⁻¹ | | IP44 |
| C _{400V} | 2 μ F | | 01.009 |
| t _R | 70 °C | | 2,6 kg |

Geräusche / Sound levels:

| LWA _{rel} A-bewertet bei V=0,5*V _{max} LWA _{rel} A-weighted at V=0,5*V _{max} | fM [Hz] | | | | | | |
|---|---------|-----|-----|----|----|----|----|
| | 125 | 250 | 500 | 1K | 2K | 4K | 8K |
| LWA ₂ [dB(A)] Gehäuse / casing | 31 | 34 | 33 | 32 | 32 | 23 | 18 |
| LWA ₅ [dB(A)] Ansaugseite / inlet side | 40 | 48 | 49 | 48 | 45 | 36 | 27 |
| LWA ₆ [dB(A)] Ausblasseite / outlet side | 40 | 47 | 50 | 50 | 47 | 39 | 29 |

| LWA _{rel} A-bewertet bei V=0,5*V _{max} LWA _{rel} A-weighted at V=0,5*V _{max} | fM [Hz] | | | | | | |
|---|---------|-----|-----|----|----|----|----|
| | 125 | 250 | 500 | 1K | 2K | 4K | 8K |
| LWA ₂ [dB(A)] Gehäuse / casing | 36 | 42 | 42 | 43 | 43 | 36 | 28 |
| LWA ₅ [dB(A)] Ansaugseite / inlet side | 48 | 53 | 56 | 59 | 56 | 52 | 43 |
| LWA ₆ [dB(A)] Ausblasseite / outlet side | 47 | 55 | 56 | 58 | 56 | 53 | 42 |

Schaltbild / Wiring diagram:

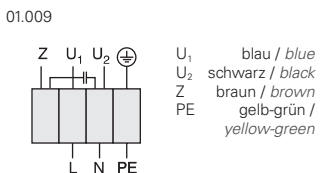

Maße / Dimensions:

(alle Maße in mm / all dimensions in mm)
R 125

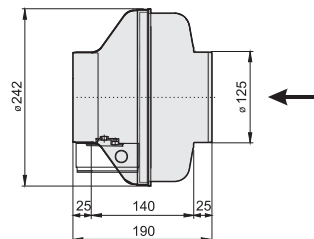

R 125 L

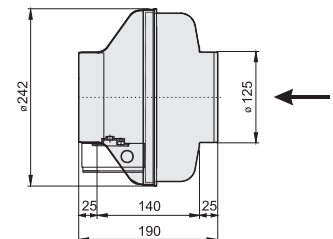

Zubehör / Accessories:

